



CE EN 1856-1:2009  
EN 14989-2:2007  
N°0071-CPR-0035  
N°0071-CPR-23062  
N°0071-CPR-24753

# APOLLO 2.0

Sistema camino coassiale in doppia parete in acciaio inox 444 sp.0,4 mm coibentato aria.

- La tubazione interna e la tubazione esterna formano due vie di flusso:
- nella via centrale vengono espulsi i fumi che si formano dalla combustione
  - nella via più esterna, tramite il terminale, convoglia l'aria che viene aspirata dall'apparecchio termico
  - la tenuta stagna è garantita senza l'utilizzo della guarnizione
  - le tubazioni hanno fascetta di bloccaggio inclusa

Air insulated concentric double wall pipe in stainless steel 444 thickness 0.4 mm.

- The inner and outer ducts create two flow paths:
- in the central duct expels the fumes produced by combustion
  - the outer duct, through the terminal, channels the air drawn in by the heating appliance
  - watertightness is guaranteed without the use of the gaskets
  - the pipes have a locking band included

Système de cheminée concentrique à double paroi en acier inoxydable 444 épaisseur 0,4 mm isolé à l'air.

- La tuyauterie interne et la tuyauterie externe forment deux voies d'écoulement :
- dans la voie centrale sont expulsés les fumées qui se forment par la combustion
  - dans la voie extérieure, via le terminal, l'air est aspiré par l'appareil thermique.
  - l'étanchéité est garantie sans l'utilisation du joint
  - les tuyaux ont un collier de serrage inclus

T450-N1-W-V2-L99040-G100

Ø disponibili  
Ø available  
Ø disponibles

80 e 100 mm

Finiture disponibili  
Available finishes  
Finitions disponibles

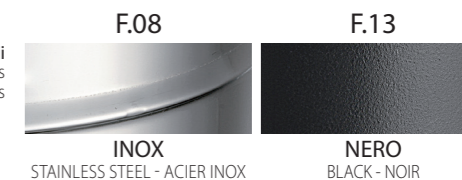



### T150

Elemento lineare  
Linear element - Élément droit

Finiture disponibili - Available finishes - Finitions disponibles

F.08 - ACCIAIO INOX STAINLESS STEEL - ACIER INOX		F.13 - NERO BLACK - NOIR		Øi	Øe	LU	📦
AP080T150		APN080T150		80	130	88	1
AP100T150		APN100T150		100	150	88	1

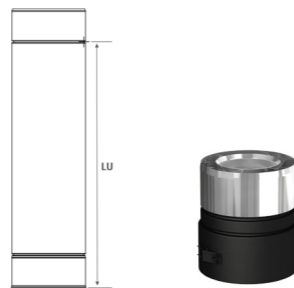

### T250

Elemento lineare  
Linear element - Élément droit

Finiture disponibili - Available finishes - Finitions disponibles

F.08 - ACCIAIO INOX STAINLESS STEEL - ACIER INOX		F.13 - NERO BLACK - NOIR		Øi	Øe	LU	📦
AP080T250		APN080T250		80	130	188	1
AP100T250		APN100T250		100	150	188	1

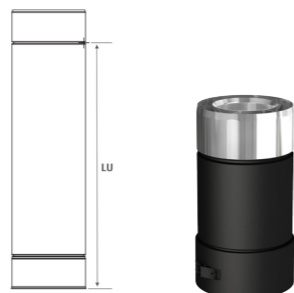

### T500

Elemento lineare  
Linear element - Élément droit

Finiture disponibili - Available finishes - Finitions disponibles

F.08 - ACCIAIO INOX STAINLESS STEEL - ACIER INOX		F.13 - NERO BLACK - NOIR		Øi	Øe	LU	📦
AP080T500		APN080T500		80	130	438	1
AP100T500		APN100T500		100	150	438	1

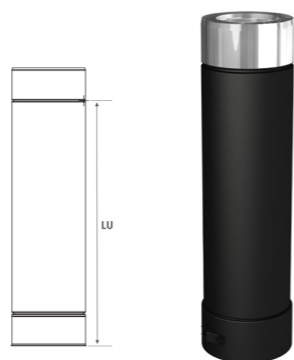

### T100

Elemento lineare  
Linear element - Élément droit

Finiture disponibili - Available finishes - Finitions disponibles

F.08 - ACCIAIO INOX STAINLESS STEEL - ACIER INOX		F.13 - NERO BLACK - NOIR		Øi	Øe	LU	📦
AP080T100		APN080T100		80	130	938	1
AP100T100		APN100T100		100	150	938	1



### TELE

Elemento telescopico  
Telescopic element - Élément télescopique

Finiture disponibili - Available finishes - Finitions disponibles

F.08 - ACCIAIO INOX STAINLESS STEEL - ACIER INOX		F.13 - NERO BLACK - NOIR		Øi	Øe	LU mini	LU maxi	📦
AP080TELE		APN080TELE		80	130	350	540	1
AP100TELE		APN100TELE		100	150	350	540	1

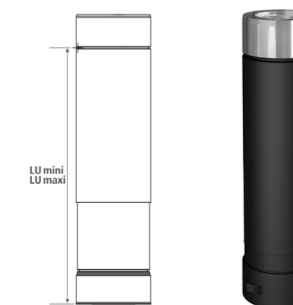

### AF10

Elemento lineare completo di analisi fumi  
Linear element with smoke analysis - Élément droit avec analyse des fumées

Finiture disponibili - Available finishes - Finitions disponibles

F.08 - ACCIAIO INOX STAINLESS STEEL - ACIER INOX		F.13 - NERO BLACK - NOIR		Øi	Øe	LU	A	📦
AP080AF10		APN080AF10		80	130	138	80	1
AP100AF10		APN100AF10		100	150	138	80	1

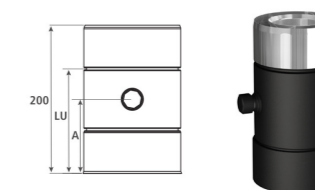

### C090

Curva a 90°  
90° Bend - Coude 90°

Finiture disponibili - Available finishes - Finitions disponibles

F.08 - ACCIAIO INOX STAINLESS STEEL - ACIER INOX		F.13 - NERO BLACK - NOIR		Øi	Øe	A	B	📦
AP080C090		APN080C090		80	130	176	122	1
AP100C090		APN100C090		100	150	176	122	1

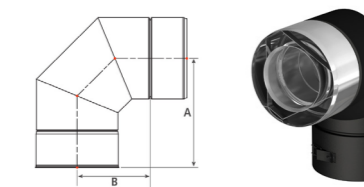

### C045

Curva a 45°  
45° Bend - Coude 45°

Finiture disponibili - Available finishes - Finitions disponibles

F.08 - ACCIAIO INOX STAINLESS STEEL - ACIER INOX		F.13 - NERO BLACK - NOIR		Øi	Øe	A	B	C	D	📦
AP080C045		APN080C045		80	130	112	52	37	79	1
AP100C045		APN100C045		100	150	112	52	37	79	1

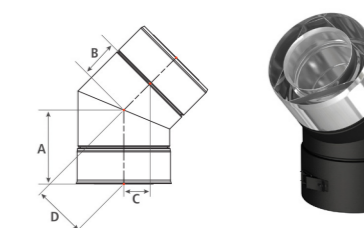

### C030

Curva a 30°  
30° Bend - Coude 30°

Finiture disponibili - Available finishes - Finitions disponibles

F.08 - ACCIAIO INOX STAINLESS STEEL - ACIER INOX		F.13 - NERO BLACK - NOIR		Øi	Øe	A	B	C	D	📦
AP080C030		APN080C030		80	130	101	45	19	50	1
AP100C030		APN100C030		100	150	101	45	19	50	1

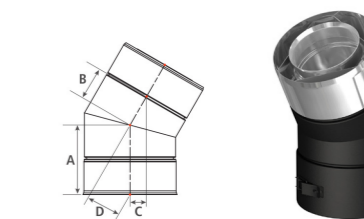



### T90F

Raccordo a "T" 90° con stacco femmina

Tee pipe fitting with female coupler - Té 90° avec débouchure femelle

Finiture disponibili - Available finishes - Finitions disponibles

F.08 - ACCIAIO INOX STAINLESS STEEL - ACIER INOX		F.13 - NERO BLACK - NOIR		Øi	Øe	A	B	C	
AP080T90F		APN080T90F		80	130	174	120	130	1
AP100T90F		APN100T90F		100	150	201	131	135	1

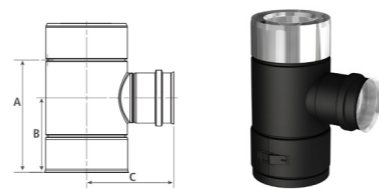

### T90A

Raccordo a "T" 90° con stacco per tubo flessibile

Tee pipe fitting with coupler for flexible pipe - Té 90° avec débouchure pour tubage flexible

Finiture disponibili - Available finishes - Finitions disponibles

F.08 - ACCIAIO INOX STAINLESS STEEL - ACIER INOX		F.13 - NERO BLACK - NOIR		Øi	Øe	A	B	C	
AP080T90A		APN080T90A		80	130	174	120	140	1
AP100T90A		APN100T90A		100	150	201	131	145	1

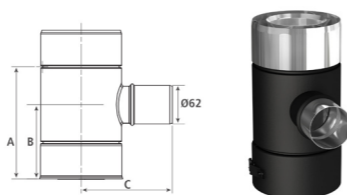

### RID/AR

Riduzione

Reducer - Réduction

CODICE CODE - CODE	Ø1	Ø2		
AP080F060M	80F	60M	1	
AR60F40F	60F	40F	1	in EPDM
AR60F50F	60F	50F	1	in EPDM



### RID

Adattatore doppia parete

Adaptor double wall - Adaptateur double paroi

CODICE CODE - CODE	
APNRID01	1
APNRID02	1

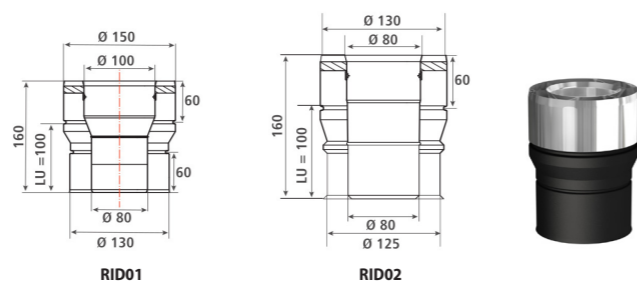

### FP23/54

Faldale per tetti piani

Flashing for flat roofs - Solin pour toits plats

ALLUMINIO ALUMINIUM ALUMINIUM

F.08 - ACCIAIO INOX STAINLESS STEEL - ACIER INOX		F.10 - NERO BLACK - NOIR		Ø	L1	L2	
J130FP23		PJ130FP23		130	550	650	1
J150FP23		PJ150FP23		150	550	650	1

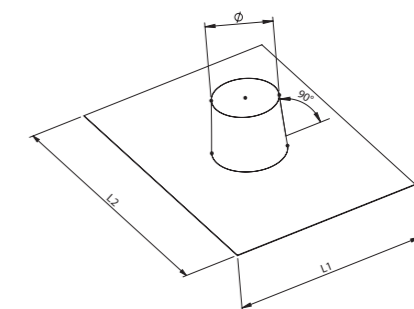
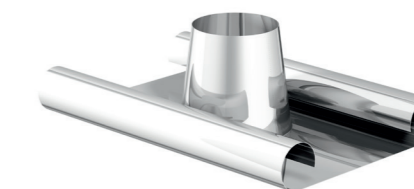

PIOMBO LEAD PLOMB

F.08 - ACCIAIO INOX STAINLESS STEEL - ACIER INOX		F.10 - NERO BLACK - NOIR		Ø	L1	L2	
J130FP54		PJ130FP54		130	700	1000	1
J150FP54		PJ150FP54		150	700	1000	1

### FI20/51

Faldale per tetti inclinati da 10° a 35°

Flashing for sloped roofs from 10° to 35° - Solin pour toits inclinés de 10° à 35°

ALLUMINIO ALUMINIUM ALUMINIUM

F.08 - ACCIAIO INOX STAINLESS STEEL - ACIER INOX		F.10 - NERO BLACK - NOIR		Ø	L1	L2	
J130FI20		PJ130FI20		130	550	650	1
J150FI20		PJ150FI20		150	550	650	1

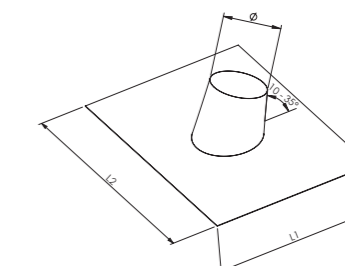
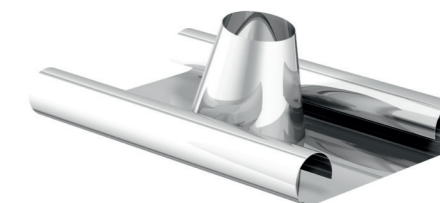

PIOMBO LEAD PLOMB

F.08 - ACCIAIO INOX STAINLESS STEEL - ACIER INOX		F.10 - NERO BLACK - NOIR		Ø	L1	L2	
J130FI51		PJ130FI51		130	700	1000	1
J150FI51		PJ150FI51		150	700	1000	1

### SS22

Scossalina

Collar - Collettere de solin

Finiture disponibili - Available finishes - Finitions disponibles

F.08 - ACCIAIO INOX STAINLESS STEEL - ACIER INOX		F.10 - NERO BLACK - NOIR		Ø1	Ø2	
J130SS22		PJ130SS22		130	230	1
J150SS22		PJ150SS22		150	250	1

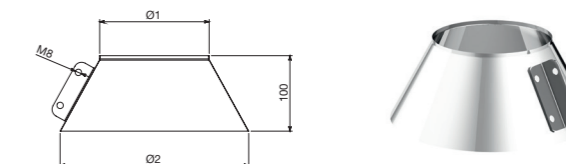



### FI30/31

Faldale con base in gomma per tetti inclinati da 5° a 32°

Flashing with rubber base for sloped roofs from 5° to 32°

Solin avec base en gomme pour toits inclinés de 5° à 32°

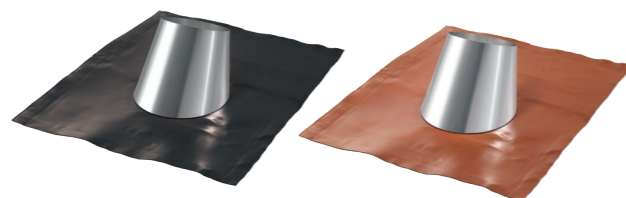

Finiture disponibili - Available finishes - Finitions disponibles

F.08 - ACCIAIO INOX STAINLESS STEEL - ACIER INOX		F.10 - NERO BLACK - NOIR		Ø	L1	L2	☐
J130FI30		PJ130FI30		130	560	688	1
J150FI30		PJ150FI30		150	560	715	1
Base in gomma rossa - Base in red rubber Base en gomme rouge							

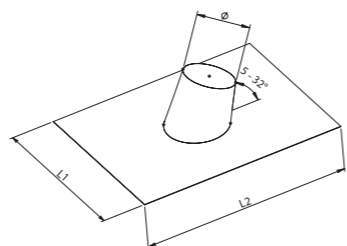

Finiture disponibili - Available finishes - Finitions disponibles

F.08 - ACCIAIO INOX STAINLESS STEEL - ACIER INOX		F.10 - NERO BLACK - NOIR		Ø	L1	L2	☐
J130FI31		PJ130FI31		130	560	688	1
J150FI31		PJ150FI31		150	560	715	1
Base in gomma nera - Base in black rubber Base en gomme noir							

Faldale extra-flex con base adesiva, molto malleabile adattabile ad ogni tipologia di tetto.  
Flashing in extra-flex rubber with adhesive base, very malleable and adaptable to any type of sloped roof.  
Solin en extra-flex gomme avec base adhésive, très malléable et adaptable à chaque typologie de toit.

### FI35/36

Faldale con base in gomma per tetti inclinati da 33° a 45°

Flashing with rubber base for sloped roofs from 33° to 45°

Solin avec base en gomme pour toits inclinés de 33° à 45°

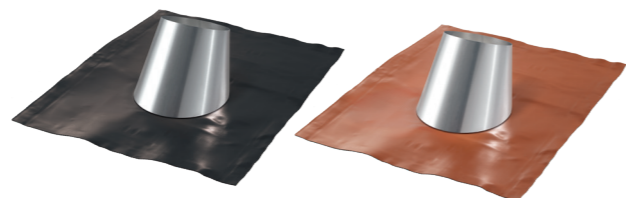

Finiture disponibili - Available finishes - Finitions disponibles

F.08 - ACCIAIO INOX STAINLESS STEEL - ACIER INOX		F.10 - NERO BLACK - NOIR		Ø	L1	L2	☐
J130FI35		PJ130FI35		130	560	685	1
J150FI35		PJ150FI35		150	560	715	1
Base in gomma rossa - Base in red rubber Base en gomme rouge							

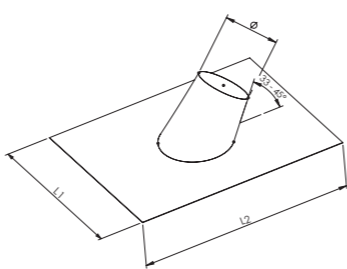

Finiture disponibili - Available finishes - Finitions disponibles

F.08 - ACCIAIO INOX STAINLESS STEEL - ACIER INOX		F.10 - NERO BLACK - NOIR		Ø	L1	L2	☐
J130FI36		PJ130FI36		130	560	685	1
J150FI36		PJ150FI36		150	560	715	1
Base in gomma nera - Base in black rubber Base en gomme noir							

Faldale extra-flex con base adesiva, molto malleabile adattabile ad ogni tipologia di tetto.  
Flashing in extra-flex rubber with adhesive base, very malleable and adaptable to any type of sloped roof.  
Solin en extra-flex gomme avec base adhésive, très malléable et adaptable à chaque typologie de toit.

### PB10

Supporto murale completo di piastra

Support mural complet de plaque - Wall bracket complete of plate

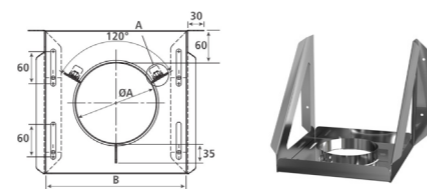

Finiture disponibili - Available finishes - Finitions disponibles

F.08 - ACCIAIO INOX STAINLESS STEEL - ACIER INOX		ØA	B	C	D	E	☐
AP130PB10		130	240	255	290	320	1
AP150PB10		150	260	265	300	330	1

### AIRP

Terminale orizzontale

Horizontal cowl - Terminal horizontal

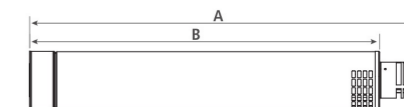

Finiture disponibili - Available finishes - Finitions disponibles

F.08 - ACCIAIO INOX STAINLESS STEEL - ACIER INOX		F.13 - NERO BLACK - NOIR		Øi	Øe	A	B	☐
AP080AIRP		APN080AIRP		80	130	883	800	1
AP100AIRP		APN100AIRP		100	150	883	800	1

### CAP2

Griglia di scarico orizzontale

Horizontal grill cowl - Chapeau horizontal avec grille de décharge

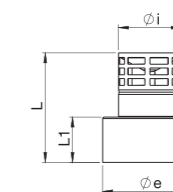

Finiture disponibili - Available finishes - Finitions disponibles

F.08 - ACCIAIO INOX STAINLESS STEEL - ACIER INOX		F.13 - NERO BLACK - NOIR		Øi	Øe	L	L1	☐
AP080CAP2		APN080CAP2		80	150	140	60	1
AP100CAP2		APN100CAP2		100	175	140	60	1

### AIRT

Terminale concentrico

Concentric cowl - Terminal concentrique

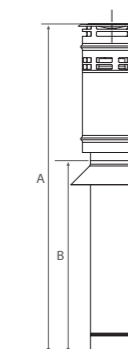

Finiture disponibili - Available finishes - Finitions disponibles

F.08 - ACCIAIO INOX STAINLESS STEEL - ACIER INOX		F.13 - NERO BLACK - NOIR		Øi	Øe	A	B	☐
AP080AIRT		APN080AIRT		80	150	995	578	1
AP100AIRT		APN100AIRT		100	175	995	578	1

### FM14

Fascetta murale

Wall clamp - Bride murale

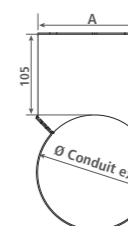
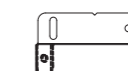

Finiture disponibili - Available finishes - Finitions disponibles

F.08 - ACCIAIO INOX STAINLESS STEEL - ACIER INOX		F.13 - NERO BLACK - NOIR		Ø	☐
APJ130FM14		APN130FM14		130	1
APJ150FM14		APN150FM14		150	1

### FORX2

Fascetta con staffe L1000 mm per supporto a tetto

Clamp with brackets L1000 mm for roof support

Bride avec traversés L1000 mm pour support au toit

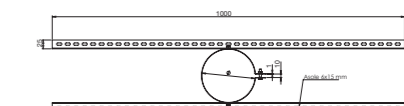

Finiture disponibili - Available finishes - Finitions disponibles

F.08 - ACCIAIO INOX STAINLESS STEEL - ACIER INOX		Ø	☐
Z130FORX2		130	1
Z150FORX2		150	1



## ROSE

Rosone magnetico  
Magnetic ring - Rosace aimantée

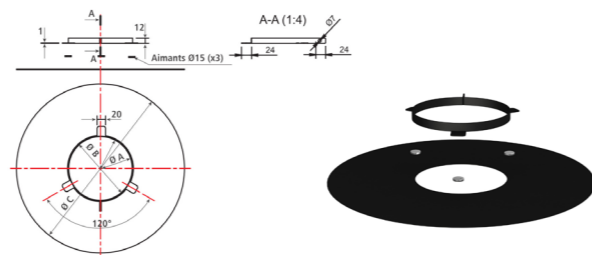

Finiture disponibili - Available finishes - Finitions disponibles

F.13 - NERO BLACK - NOIR	ØA	ØB	ØC	📦
APN130ROSE	130	137	377	1
APN150ROSE	150	155	385	1

## FIN1

Piastra quadrata di finitura da 10° a 30°  
Square finishing plate from 10° to 30°  
Plaque carrée de finition de 10° à 30°

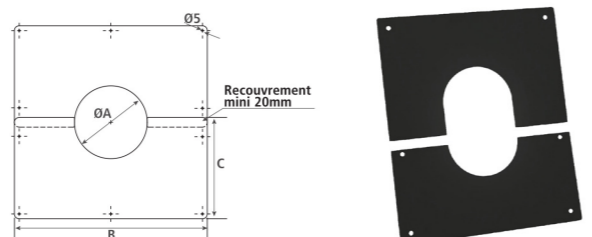

Finiture disponibili - Available finishes - Finitions disponibles

F.08 - ACCIAIO INOX STAINLESS STEEL - ACIER INOX	F.10 - NERO BLACK - NOIR	ØA	B	C	📦
APJ130FIN1	APN130FIN1	133	400	210	1
APJ150FIN1	APN150FIN1	151	400	240	1

## PLQ

Piastra in EPDM con base adesiva  
Plate in EPDM with adhesive base  
Plaque en EPDM avec base adhesive

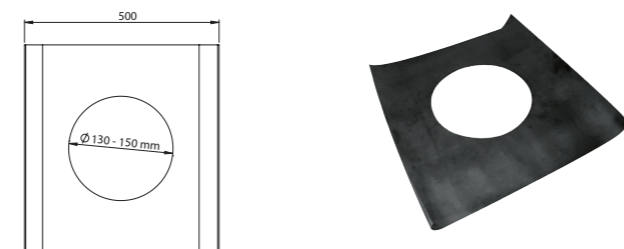

CODICE CODE - CODE	📦
APUNVPLQ	1

## TFSI

Tubo flessibile in EPDM  
Flexible pipe in EPDM - Tuyau flexible en EPDM

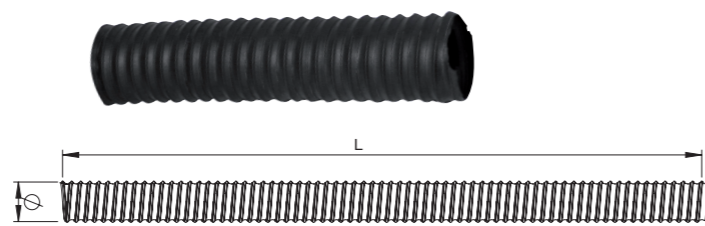

CODICE CODE - CODE	Ø	L	📦	in EPDM
AD060TFSI	60	1000	1 mt	

## COPA

Coppella con rivestimento in alluminio resistente fino a 600°C  
Thermal insulation with aluminium coating resistant up to 600°C  
Isolation thermique avec revêtement en aluminium résistant jusqu'à 600°C

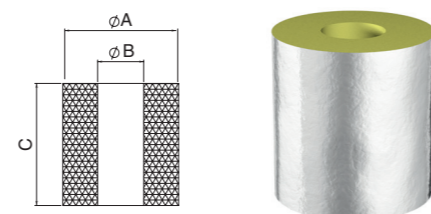

CODICE CODE - CODE	Ø	A	B	C	📦
AK130COPA	130	331	131	400	1
AK150COPA	150	349	149	400	1

Coppelle in lana di roccia per canne fumarie densità 90Kg/m³ - Rock wool insulation for chimney systems density 90 kg/m³ - Isolation de laine de roche pour conduits de cheminée densité 90 kg/m³

## INTERNO COSTRUZIONE

Inside of the building - Intérieur de bâtiment

Condotto concentrico con terminale verticale  
**CONFIGURAZIONE CONCENTRICA, CIRCUITO DI COMBUSTIONE ERMETICO\***  
\*Gli apparecchi a pellet devono essere in possesso di un parere tecnico per essere installati nel circuito di combustione stagno

Concentric duct with vertical cowl  
**CONFIGURATION CONCENTRIQUE, HERMETIC COMBUSTION CIRCUIT\***  
\*Pellet appliances must be supported by a technical opinion in order to be installed in a sealed combustion circuit

Conduit concentrique avec terminal vertical  
**CONFIGURATION CONCENTRIQUE, CIRCUIT DE COMBUSTION ÉTANCHE\***  
\*Les appareils à granulés de bois doivent être titulaires d'un avis technique pour être installés en circuit de combustion étanche

## ESTERNO COSTRUZIONE

Outside of the building - Extérieur de bâtiment

Condotto doppia parete isolato  
**CONFIGURAZIONE ESTERNA, CIRCUITO DI COMBUSTIONE ERMETICO**  
Insulated double wall duct  
**EXTERNAL CONFIGURATION, SEALED COMBUSTION CIRCUIT**

Conduit DP isolé  
**CONFIGURATION EXTÉRIEURE, CIRCUIT DE COMBUSTION ÉTANCHE**

## RIUTILIZZO DI UN CONDOTTO ESISTENTE

Reuse of an existing pipeline - Réutilisation d'un conduit existant

Tubo flessibile  
**CONFIGURAZIONE SEPARATA, CIRCUITO DI COMBUSTIONE NON IMPERMEABILE CON PRESA D'ARIA NELLA STANZA**

Flexible pipe  
**SEPARATE CONFIGURATION, NON-IMPERMEABLE COMBUSTION CIRCUIT WITH AIR IN-ROOM**

Tubage flexible  
**CONFIGURATION SÉPARÉE, CIRCUIT DE COMBUSTION NON ÉTANCHE AVEC PRISE D'AIR DANS LA PIÈCE**

